

PEX MULTI LAYER PIPES AND FITTINGS

COMPLY WITH BS EN ISO 21003-1:2008
 BS EN ISO 21003-3:2008
 BS EN ISO 21003-5:2008
 BS EN 12165:2016
 AS/NZS 4020:2005 / 2018
 SS 375:2015

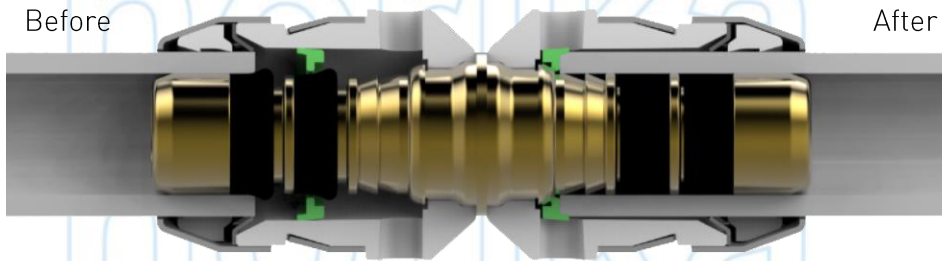

F6 PUSH-FIT



COMPONENTS:

Body

The main body of F6 PUSH-FIT is made out of Brass CW602N material, which greatly improves the corrosion resistance, eliminates processing stress, and ensures no cracking and dimensional stability.

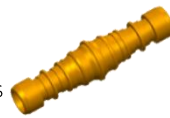

Collet

Using imported PPSU, F6 PUSH-Fit has high strength, heat resistance and stable chemical properties, health and environmental protection. Inspection holes provide visual verification to check whether the tube is fully inserted.



Collet Retainer

High-strength 304 stainless steel performs excellent corrosion resistance and formability. The collet retainer can fix the fittings to prevent them from falling off.



Grab Ring

High-strength 316 stainless steel with good corrosion resistance. The inverted tooth structure can effectively hold the pipe and prevent it from coming out.



Seal Ring

High-quality EPDM material with excellent weather resistance and corrosion resistance. Double seal to ensure no leakage.



Protection Cap

Safe and environmentally friendly PP material, with strong strength, effectively preventing the entry of impurities and protecting the fitting.



Seal Ring

High-quality EPDM material with excellent weather resistance and corrosion resistance. Double seal to ensure no leakage.



Protection Cap

Safe and environmentally friendly PP material, with strong strength, effectively preventing the entry of impurities and protecting the fitting.



STANDARD SPECIFICATION

Working Pressure	10 Bar
Working Temperature	0 ~ 85°C
Applications	Hot and cold potable water system, Underfloor heating system